

JDCC  
5 April 2023



**GREATER CAMBRIDGE**  
SHARED PLANNING

# 21/05434/REM – Parcel BDW3, Darwin Green 1, Land between Huntingdon Road and Histon Road

Proposal: Reserved Matters application for third housing phase (known as BDW3) including 210 dwellings with associated internal roads, car parking, landscaping, amenity and public open space. The Reserved Matters include access, appearance, landscaping, layout and scale and related partial discharge of conditions 8, 10, 14, 17, 18, 22, 25, 26, 28, 35, 40, 49, 58, 62, 66, and 69 pursuant to outline approval 07/0003/OUT

# Site Location Plan

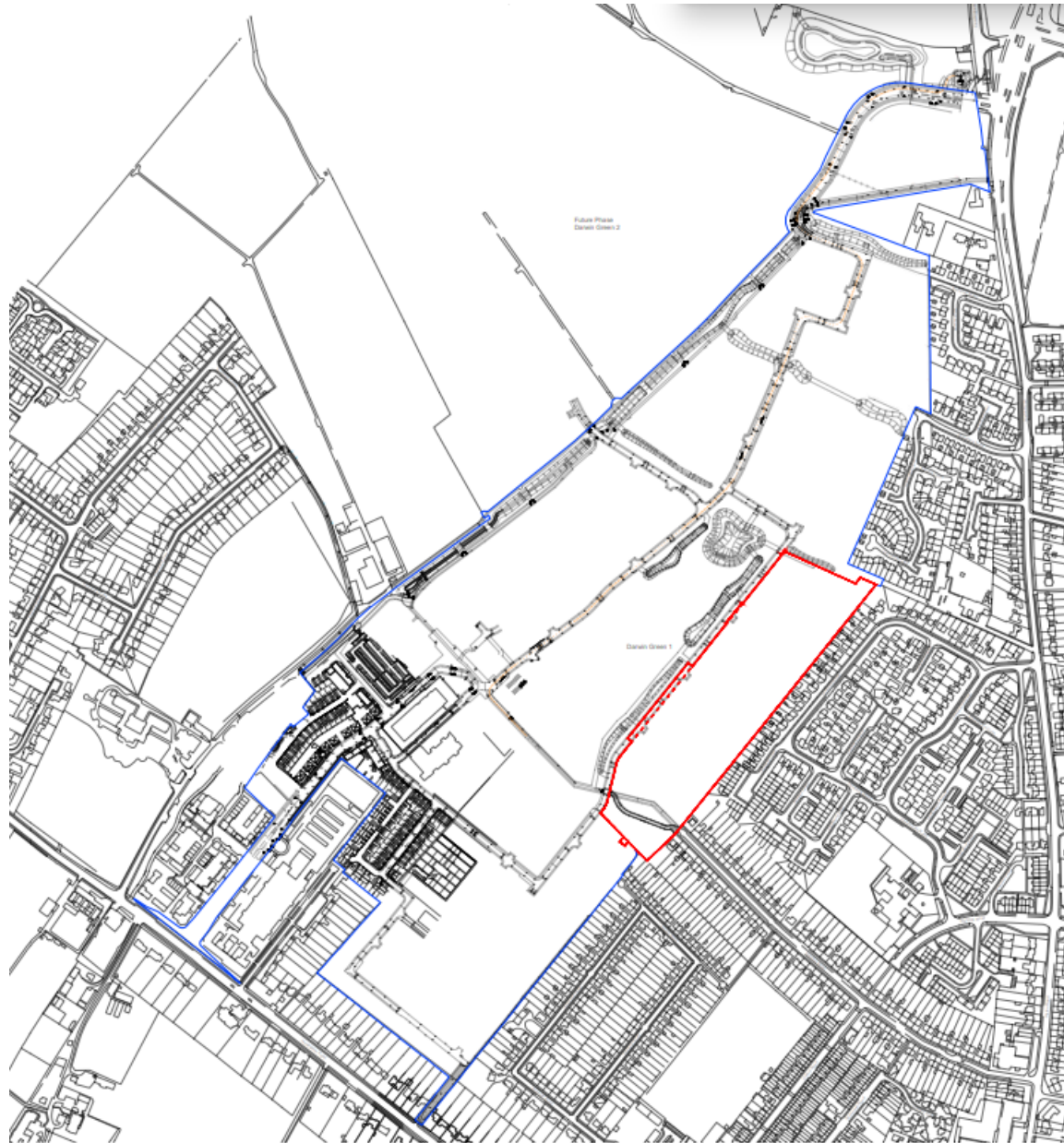
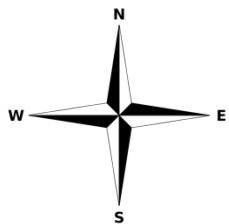

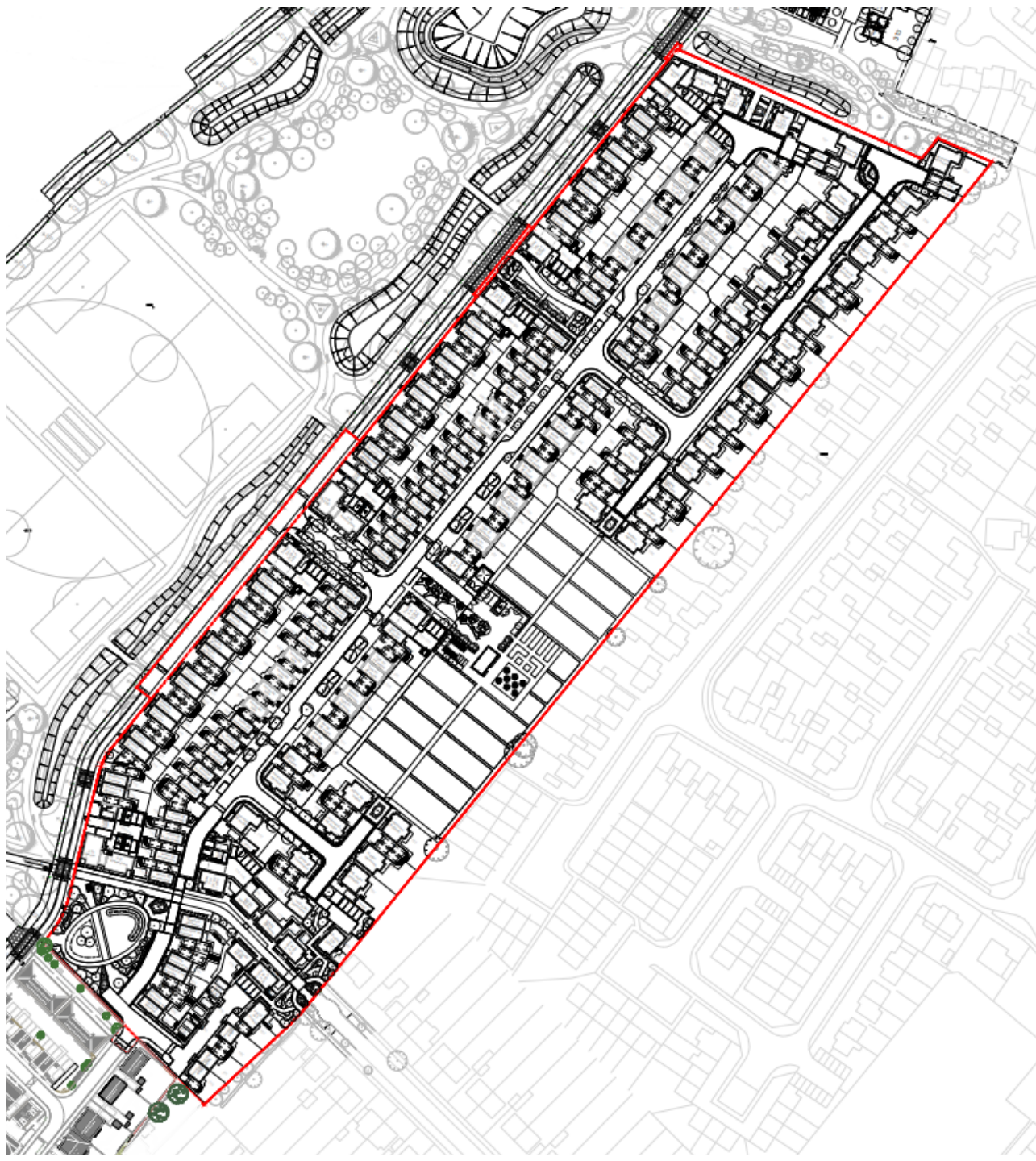
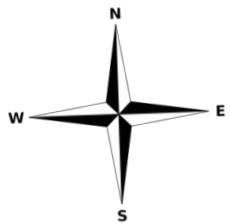

# Typical Apartment Block



1

**Front Elevation**

1 : 200



2

**Side Elevation**

1 : 200



3

**Rear Elevation**

1 : 200

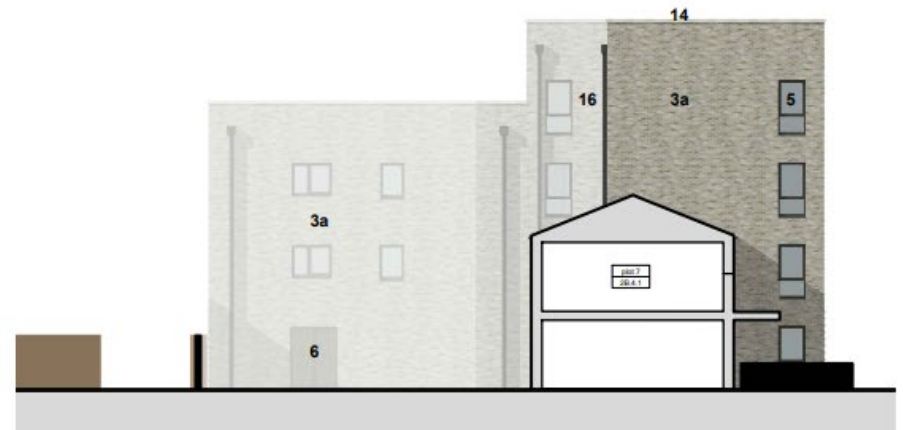

4

**Side Elevation**

1 : 200

# Typical Walk-up Block

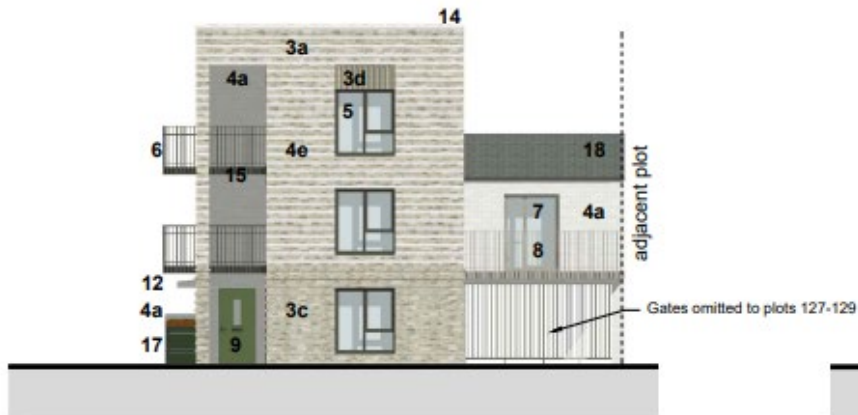

1 **Front Elevation 1**  
1 : 200

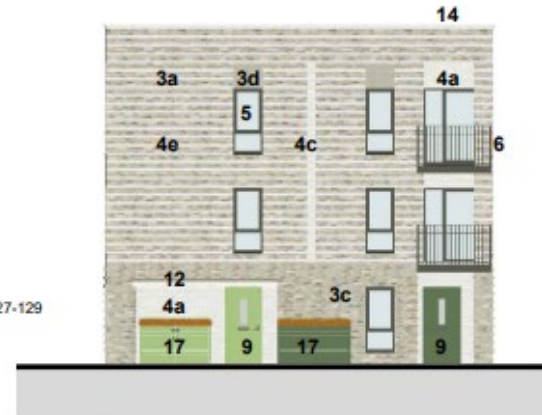

2 **Front Elevation 2**  
1 : 200

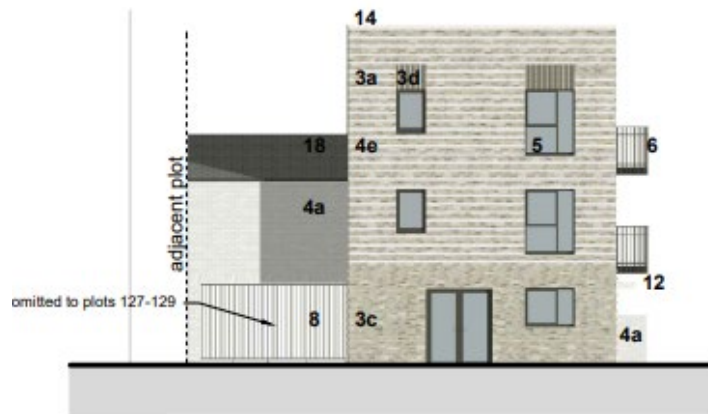

3 **Rear Elevation**  
1 : 200

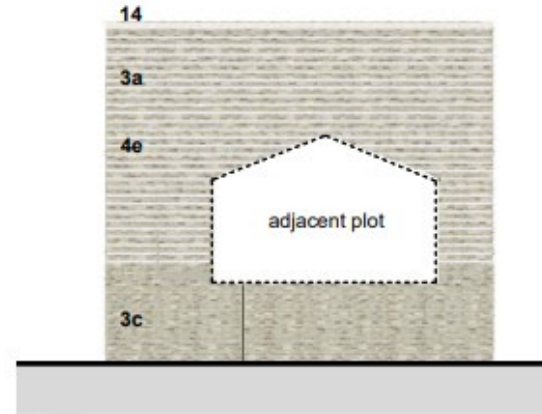

4 **Side Elevation**  
1 : 200

# Typical primary Street House



1 **Proposed Front Elevation**  
1:100

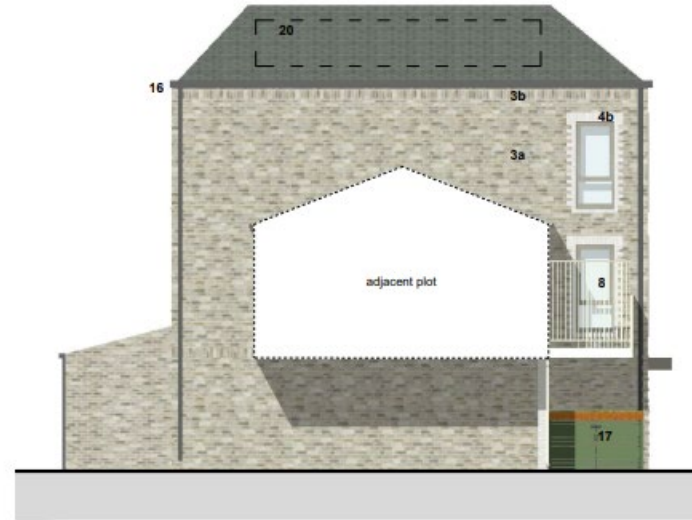

3 **Proposed Side Elevation**  
1:100



2 **Proposed Rear Elevation**  
1:100

# Typical tertiary Street House



1 **Proposed Front Elevation**  
1 : 100

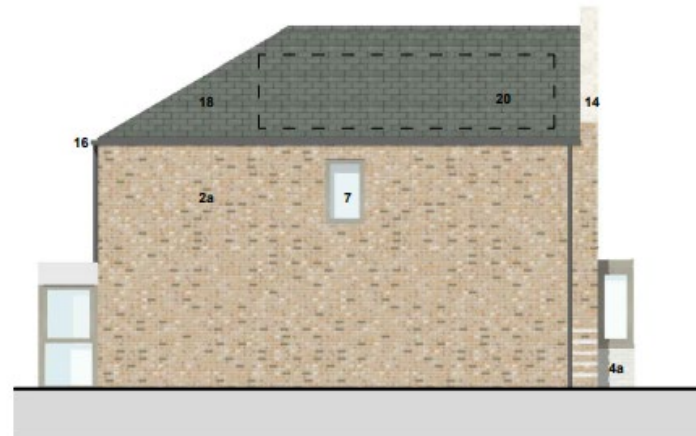

3 **Proposed Side Elevation**  
1 : 100



2 **Proposed Rear Elevation**  
1 : 100

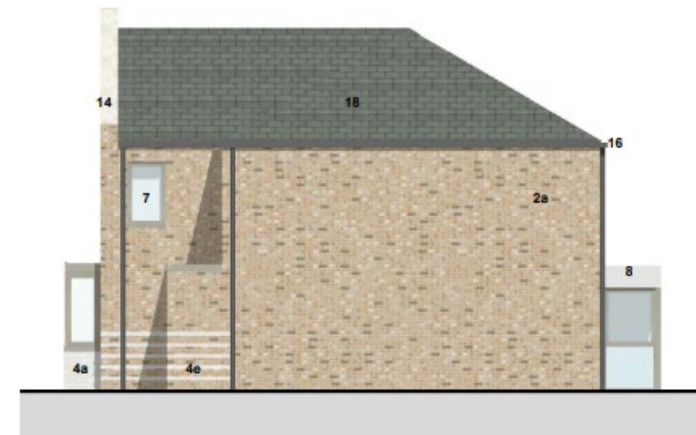

4 **Proposed Side Elevation**  
1 : 100

# Typical Flat over Garage



1 **Proposed Front Elevation**  
1 : 100

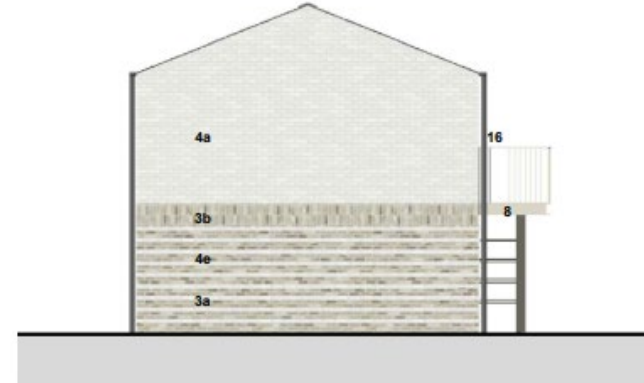

3 **Proposed Side Elevation**  
1 : 100

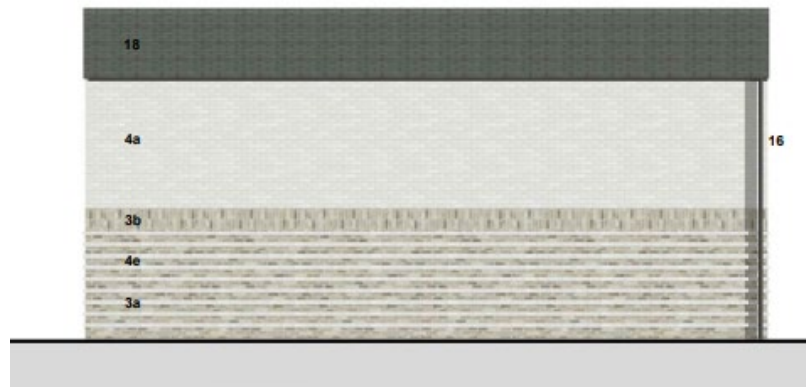

2 **Proposed Rear Elevation**  
1 : 100

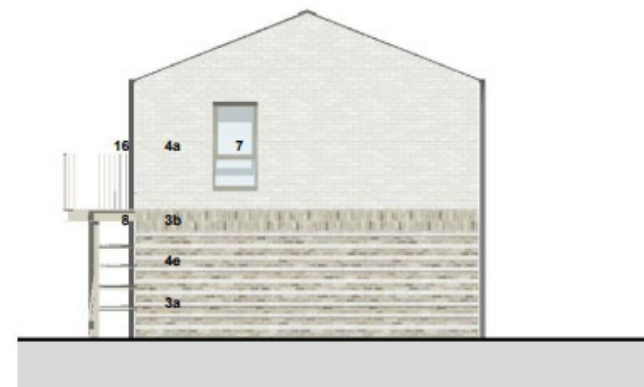

4 **Proposed Side Elevation**  
1 : 100

# Site sections - Primary street





# Site sections - southern boundary



# Site sections - northern boundary

